

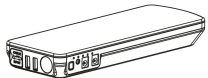

ENERGY STATION LC18-ES

Thank you for choosing the Energy Station! Always follow basic safety precautions when using electrical appliances. Read all instructions carefully. Please keep this instruction manual for easy reference.



A. PRODUCT LAYOUT :

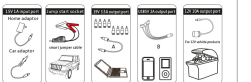
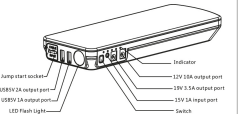

B. OPERATION GUIDANCE

Indicator

Press the switch to check the storage level of Energy Station.

Indicator	Unit	5-Flashing	1 solid	2 solid	3 solid	4 solid	5 solid
Storage level	0%	10%	20%	40%	60%	80%	100%

The indicator will flash one by one during the period of charging. Different number of solid indicators show different storage level of Energy Station. All indicators light off when the charging is paused or completed.

E-Power Charging Instruction :

1. Plug the home adaptor into the universal socket.
2. Connect 15V 1A input port of Energy Station to the other end of home adaptor .

Or

1. Plug the car adaptor into the socket of cigarette lighter.
2. Connect 15V 1A input port of Energy Station to the other end of car adaptor.



Jump start 12V vehicle instruction:

1. Connect the blue plug fully sealed into the host, and make sure the Cable Indicator is off.
2. Connect Red Clamp to the positive (+) battery terminal, Black Clamp to the negative (-) battery terminal.
3. Operate following the instruction of the Cable Indicators:
GREEN Light on: mean that the connection is correct and the circuit is work, and then turn on the engine.
RED Light on and buzzing: mean that the connection is mistake, should connect correctly, and then turn on the engine.
GREEN Light blinking and buzzing: mean that the car battery

is low voltage, press the "BOOST" key, the GREEN indicator will be light on, and then turn on the engine in 30s.
All Light off and without buzzing: mean that the car battery maybe dead, please make sure the connection is correct, and then press the "BOOST" key, the GREEN indicator will be light on, and then turn on the engine in 30s.
 4. Start the vehicle.
 5. When the vehicle is started, remove the jumper cable from the vehicle battery. Leave the vehicle's engine running.



Charging Cell Phone or Tablet Instruction:

1. Plug the switch cable B to USB 5V 2A output port.
2. Select appropriate connector and connect it to your mobile phones or tablet.
3. Press the switch button to charge.
4. If doesn't work, please try another USB Output port.



Only for charging/power supply to 19V Notebook

1. Plug the switch cable A to USB 19V 3.5A output port.
2. Select appropriate connector for your Notebook and connect

- it to the switch cable A and your Notebook.
3. Press the switch button to charge/power supply.



For power supply to 12V vehicle products or 12V electronics

1. Plug the optional switch cable to 12V 10A output port.
2. Connect the optional switch cable and 12V vehicle product or 12V electronics.
3. Press the switch button to power supply.

LED flash light

Press the switch 3 seconds to start the LED flash light. There are 4 modes of LED light appear in order (normal, strobe, SOS, off) if you press slightly.

C. PARTS LIST :

#	Parts Name	Quantity	#	Parts Name	Quantity
1	Host	1	6	Car adaptor	1
2	Switch cable A	1	7	Smart jumper cable	1
3	Switch cable B	1	8	User Manual	1
4	Notebook connector	8	9	12V Adaptor	1
5	Home adaptor	1			

D. TECHNICAL SPECIFICATIONS :

Size : 230x87x27mm
Weight : 615g
Battery Capacity: 18000mAh(66.6Wh)
Output: 5V= 1A; 5V= 2A; 12V= 10A; 19V= 3.5A;
Input : 15V =1A
Full charging time : 8 hours
Starting current : 350A
Peak current : 650A
Operating temperature : -20°C - 60°C

E. FAQ :

- Q. How to turn off this appliance?
 A. This appliance will power off automatically when no load or charging is complete.

- Q. Need how long time to full charge the Energy Station?
 A. Approx. 8 hours through the 15V1A input.

- Q. How many times can this appliance charge for my cell phone?
 A. Depend on the battery capacity of your cell phone. Take iPhone4 as an example, can full charging 14 times.

- Q. How long will this appliance take to charge my cell phone full?
 A. Approx. 1 hour.

- Q. How long will this appliance on a full charge take to supply the Notebook?
 A. 4-6 hours.

- Q. How many times can this appliance jump start the vehicle if it is in full battery?
 A. Approx. 40 times.

- Q. How long does the battery last after fully charged?
 A. 6-12 months, however, we suggest to recharge it every 3 months.

- Q. How long does the battery last still can jump start the car after fully charged?
 A. 6-12 months.

F. TROUBLE SHOOTING:

Finding	Cause	Remedies
No response when pressing the switch button.	Low voltage protection of Energy Station is started.	Plug the adaptor into the 15V 1A input port to activate.
Energy Station is a bit hot when charging for Notebook.	The charging current is a bit high (3.5A)	Remove the battery of your Notebook and use the appliance to supply power directly, or disconnect Energy Station with your Notebook and contact them when it's cool.

G. TOXIC AND HARMFUL SUBSTANCES:

Composition and amount of toxic and harmful substances in Energy Station.					
Pb	Hg	Cd	Cr(VI)	PBB	PBDE
○	○	○	○	○	○

○ : Indicate all homogeneous materials' hazardous substances content are below the MCV limit specified in the Standard 2002/95/EC (RoHS).

H. Warning:

1. Always make sure the blue plug of jumper cable connect with the jump start socket tight in Energy Station before jumping start the vehicle. Otherwise, it will affect the results, even causing the melt of the blue plug.
2. Always check if the jumper clamps are well connected, check if the vehicle battery connector is rusted or dirty, clean it before jumping start the vehicle. DO NOT jump start again after 3 attempts. Otherwise, it will damage the host. And Check your vehicle if it has other trouble.
3. DO NOT connect the two clamps. Otherwise, it may be dangerous!
4. DO NOT disassemble the host. Otherwise, it may be dangerous!

I. Always take care when using the appliance

- ⊗ This appliance is not intended for use by young or infirm persons without supervision
- ⊗ Do not use as a toy
- ⊗ Do not allow the appliance to become wet
- ⊗ Do not immerse the appliance in water
- ⊗ Do not operate the appliance in explosive atmospheres, such as in the presence of flammable liquids, gases or dust
- ⊗ Do not modify or disassemble Energy Station. Only a repair technician may repair this unit
- ⊗ Do not expose the appliance to heat
- ⊗ Do not store in locations where the temperature may exceed 70 °C
- ⚡ Charge only at ambient temperatures between -20 °C and 60 °C
- ⚡ Charge only using the charger provided with the appliance
- ⚡ Under extreme conditions, battery leakage may occur. Carefully wipe the liquid off using a cloth and avoid skin contact when you notice liquid on the batteries. In case of skin or eye contact, rinse immediately with clean water and seek medical attention
- ♻️ At the end of their useful life, discard the appliance with due care for our environment

Declaration of conformity:
 We, Loadchamp (Kiriazis & Papazis GbR), Fahrlichstr. 14, 68165 Mannheim, Germany, Tel: +49 621-46098533, declare that product LOADCHAMP, Model LC18-ES – Energy Station, is in conformity with the following standards:
 EMV2004/108/EG,
 EN 50498:2010,
 EN 61000-6-3:2007+A1:2011,
 EN61000-6-1:2007,
 EN61000-3-3:2008,
 EN65015:2008+A1:2007+A2:2009,
 EN 61547:2009,
 EN61000-3-2:2008+A1:2009+A2:2009
 RoHS Richtlinie 2011/65/EU
 Mannheim 01-09-2015

Environmental protection note
 At the end of its useful life, this product must not be disposed of together with normal household waste, but has to be dropped off at a collection centre for the recycling of electrical and electronic devices. This is indicated by the symbol on the product, on the instruction manual or the on the packaging.



Applied Standard : GB/T 22827-2000